

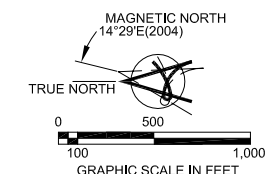

PASO ROBLES MUNICIPAL AIRPORT

AIRPORT LAND USE PLAN



NO.	ALP APPROVED REVISIONS	1/17/96 DATE
1	ALP APPROVED REVISIONS	1/17/96 DATE

FAA APPROVAL

BY _____
CITY OF PASO ROBLES DATE

ARIAS CONSULTANTS LTD.

PASO ROBLES MUNICIPAL AIRPORT
SAN LUIS OBISPO COUNTY, CALIFORNIA

SHEET
6 OF 7

NAME: PRB-6-Land Use Plan-8.dwg NO: 4080-01
DATE: November 16, 2004 PLOT SCALE: 1"=1,000'

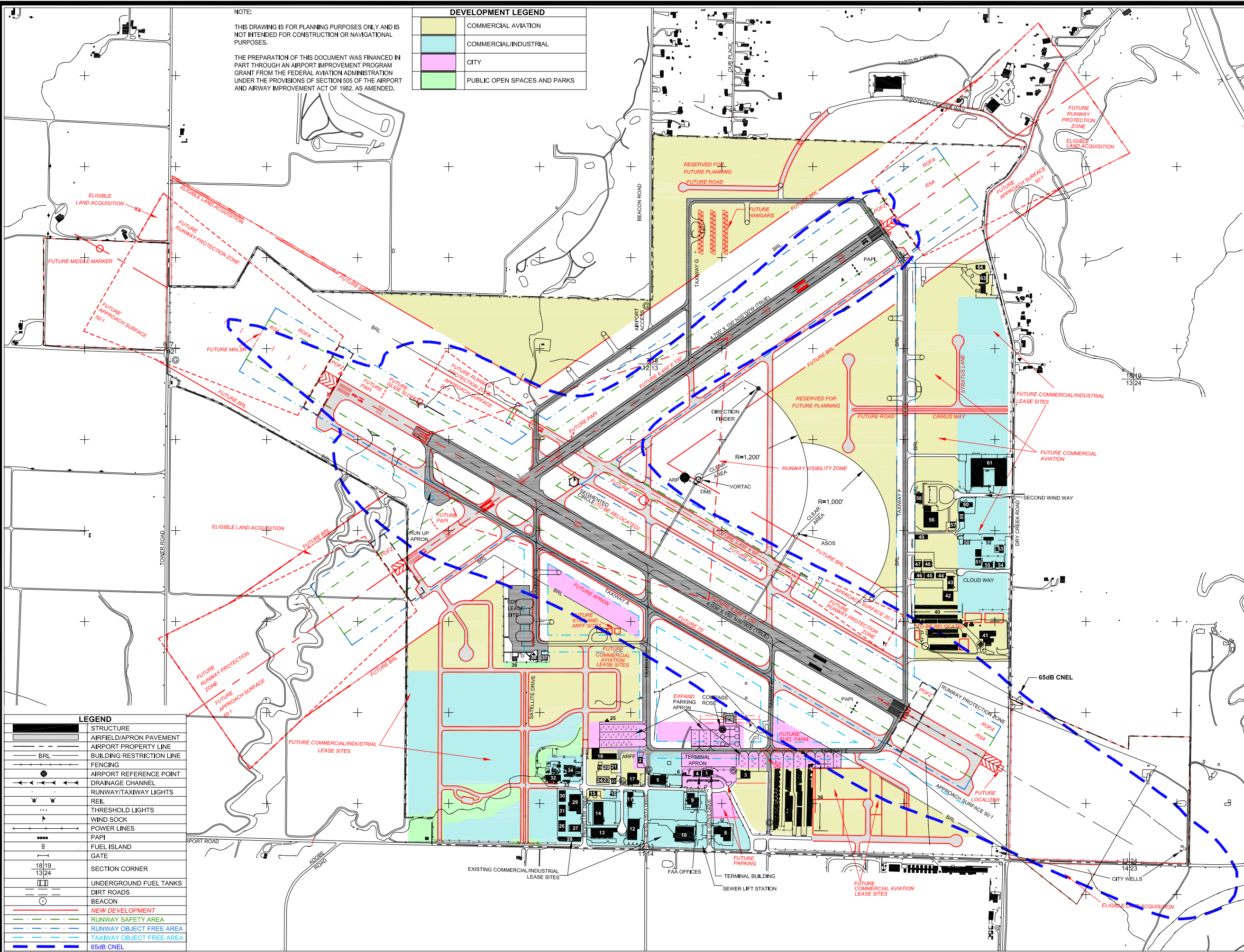

NOTE:
THIS DRAWING IS FOR PLANNING PURPOSES ONLY AND IS NOT INTENDED FOR CONSTRUCTION OR NAVIGATIONAL PURPOSES.
THE PREPARATION OF THIS DOCUMENT WAS FINANCED IN PART THROUGH AN AIRPORT IMPROVEMENT PROGRAM GRANT FROM THE FEDERAL AVIATION ADMINISTRATION UNDER THE PROVISIONS OF SECTION 505 OF THE AIRPORT AND AIRWAY IMPROVEMENT ACT OF 1982, AS AMENDED.

DEVELOPMENT LEGEND	
	COMMERCIAL AVIATION
	COMMERCIAL/INDUSTRIAL
	CITY
	PUBLIC OPEN SPACES AND PARKS

LEGEND	
	STRUCTURE
	AIRFIELD/APRON PAVEMENT
	AIRPORT PROPERTY LINE
	BUILDING RESTRICTION LINE
	FENCING
	AIRPORT REFERENCE POINT
	DRAINAGE CHANNEL
	RUNWAY/TAXIWAY LIGHTS
	REIL
	THRESHOLD LIGHTS
	WIND SOCK
	POWER LINES
	PAPI
	FUEL ISLAND
	GATE
	SECTION CORNER
	UNDERGROUND FUEL TANKS
	DIRT ROADS
	BEACON
	NEW DEVELOPMENT
	RUNWAY SAFETY AREA
	RUNWAY OBJECT FREE AREA
	TAXIWAY OBJECT FREE AREA
	65dB CNEL