

RESOLUTION NO. 13-120

A RESOLUTION OF THE CITY COUNCIL OF THE CITY OF PASO ROBLES ADOPTING
AMENDMENTS TO DEPARTMENT OF PUBLIC WORKS
STANDARD DETAILS AND SPECIFICATIONS

WHEREAS, the Circulation Element advances policy for street design to account for all users including pedestrians, children, persons with disabilities, seniors and bicyclists along with typical auto traffic; and

WHEREAS, the Circulation Element advances the concept of narrower streets that are safe to cross or walk along, that calm traffic, offer places to meet people, link neighborhoods and generally maintain a small town character; and

WHEREAS, key principles of the Economic Strategy include maintaining safe, healthy, and attractive physical environments including streetscapes.

THEREFORE, BE IT RESOLVED AS FOLLOWS:

That the City Council of the City of Paso Robles does hereby approve and adopt Standard Drawings A – 1 through A – 8 attached hereon as exhibits to the Department of Public Works Standard Details and Specifications.

PASSED AND ADOPTED by the City Council of the City of Paso Robles this 20th day of August, 2013 by the following vote:

AYES: Strong, Martin, Steinbeck, Hamon
NOES: Picanco
ABSTAIN:
ABSENT:



Duane Picanco, Mayor

ATTEST:



Caryn Jackson, Deputy City Clerk

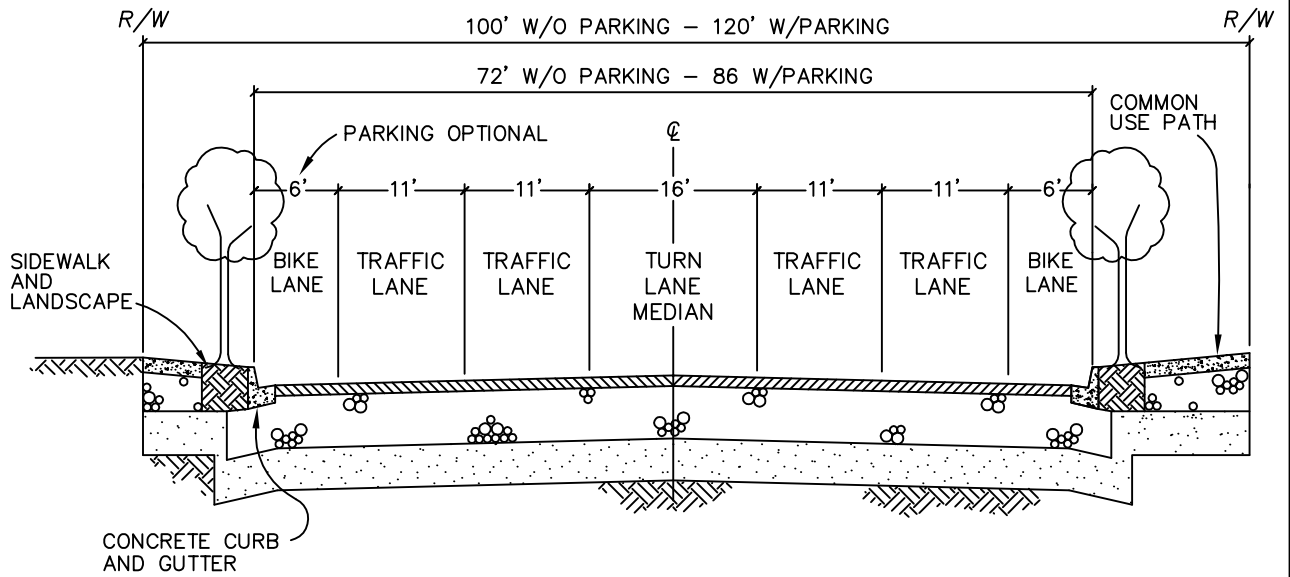

4 LANE ARTERIAL

TRAFFIC INDEX: 8.0

DESIGN SPEED: 35.0 MPH

DRAWN BY: KGE	CITY OF PASO ROBLES ENGINEERING DIVISION	DRAWING NO.
DESIGNED BY: JF		A-1
DATE: 08/13	4 LANE ARTERIAL (DIVIDED)	
FILE NAME: PR-A-1.DWG		

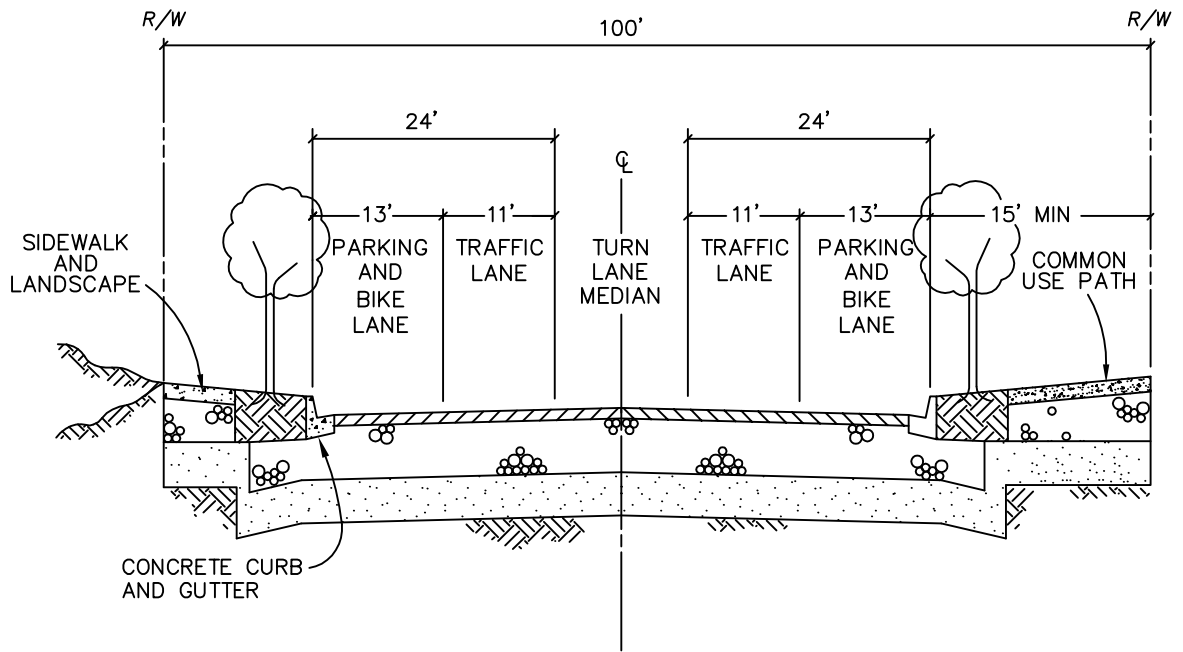

2-LANE DIVIDED ARTERIAL

TRAFFIC INDEX: 8.0
 DESIGN SPEED: 35 MPH

DRAWN BY: KGE	CITY OF PASO ROBLES ENGINEERING DIVISION	DRAWING NO.
DESIGNED BY: JF		A-2
DATE: 08/13	2-LANE DIVIDED ARTERIAL	
FILE NAME: PR-A-2.DWG		

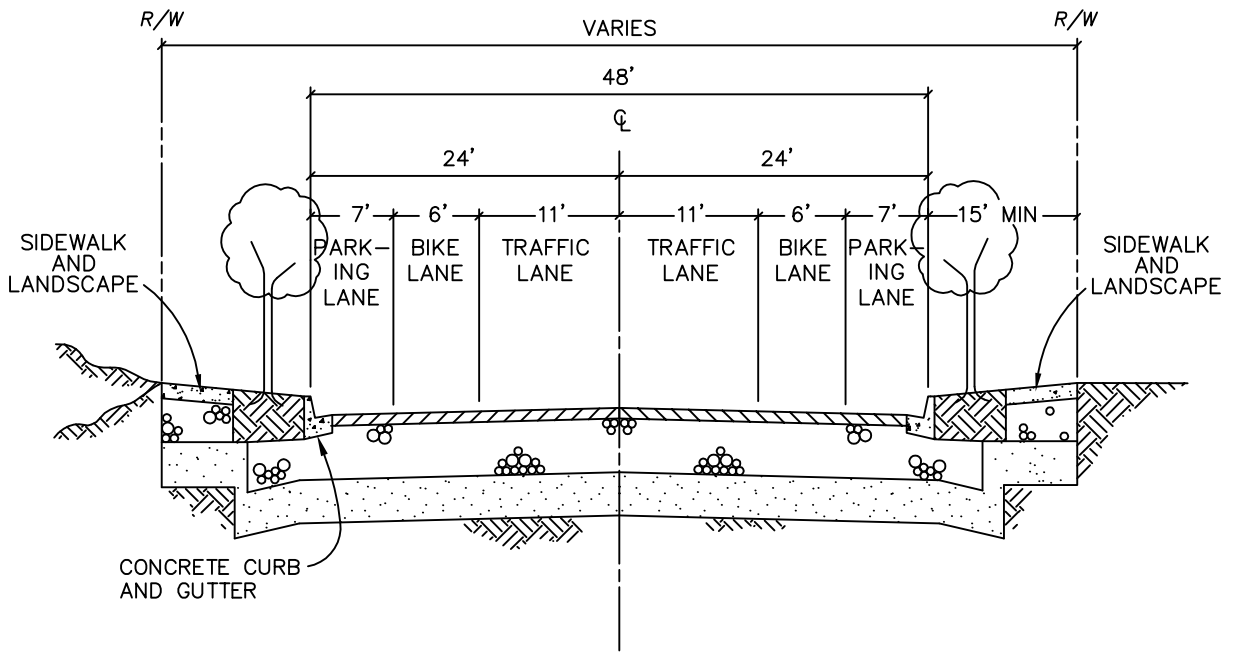

2-LANE UNDIVIDED ARTERIAL

TRAFFIC INDEX: 7.0
 DESIGN SPEED: 35 MPH

DRAWN BY: KGE	CITY OF PASO ROBLES ENGINEERING DIVISION	DRAWING NO.
DESIGNED BY: JF		A-3
DATE: 08/13	2-LANE UNDIVIDED ARTERIAL	
FILE NAME: PR-A-3.DWG		

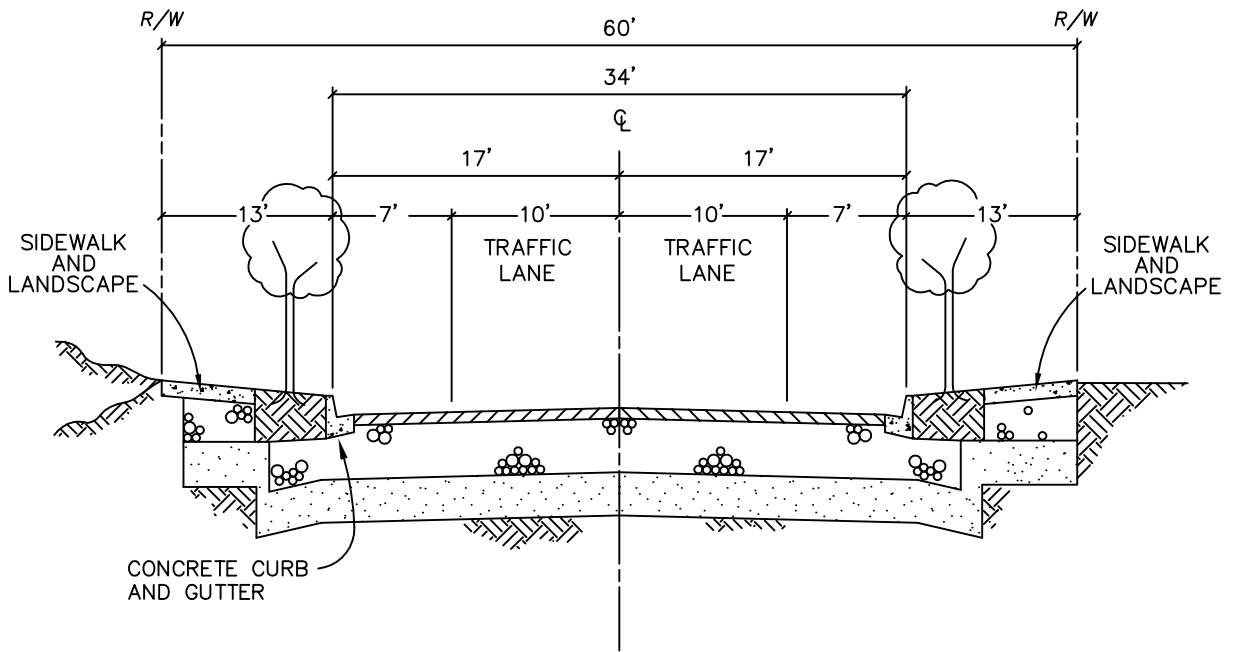

LOCAL STREET

TRAFFIC INDEX: 6.0
 DESIGN SPEED: 25 MPH

DRAWN BY: KGE	CITY OF PASO ROBLES ENGINEERING DIVISION	DRAWING NO.
DESIGNED BY: JF		A-4
DATE: 08/13	LOCAL STREET	
FILE NAME: PR-A-4.DWG		

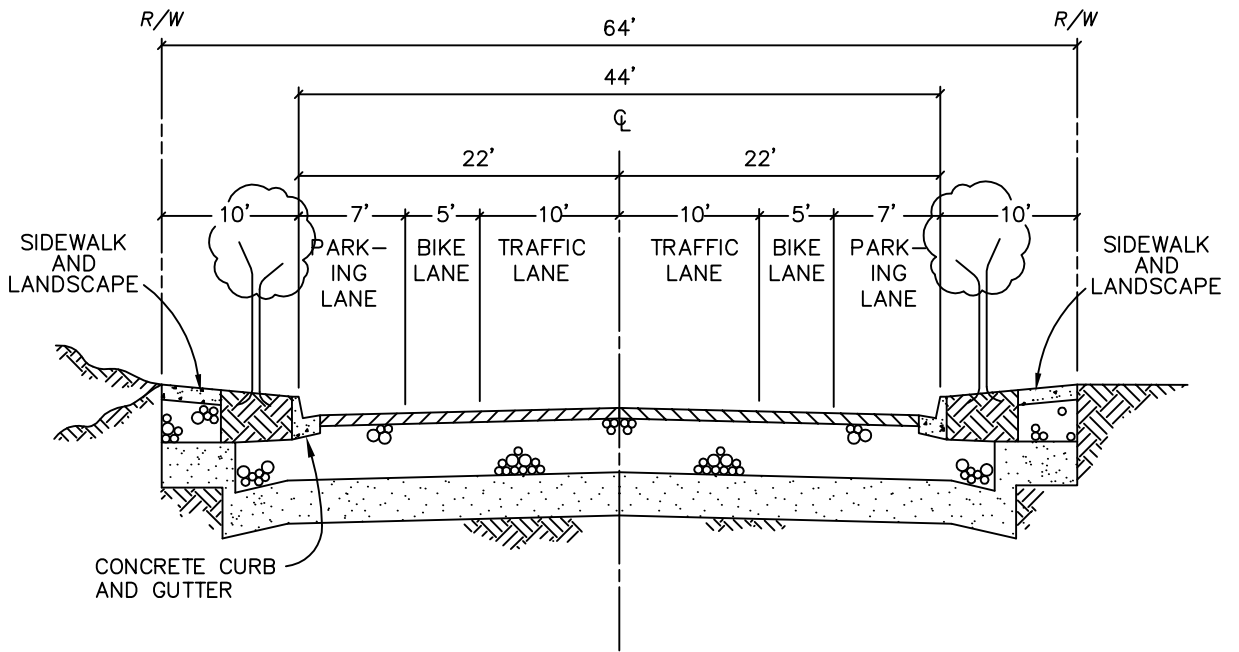

LOCAL STREET
WITH CLASS II BIKE LANES

TRAFFIC INDEX: 6.0
DESIGN SPEED: 25 MPH

DRAWN BY: KGE	CITY OF PASO ROBLES ENGINEERING DIVISION	DRAWING NO.
DESIGNED BY: JF		LOCAL STREET WITH CLASS II BIKE LANES
DATE: 08/13		
FILE NAME: PR-A-5.DWG		

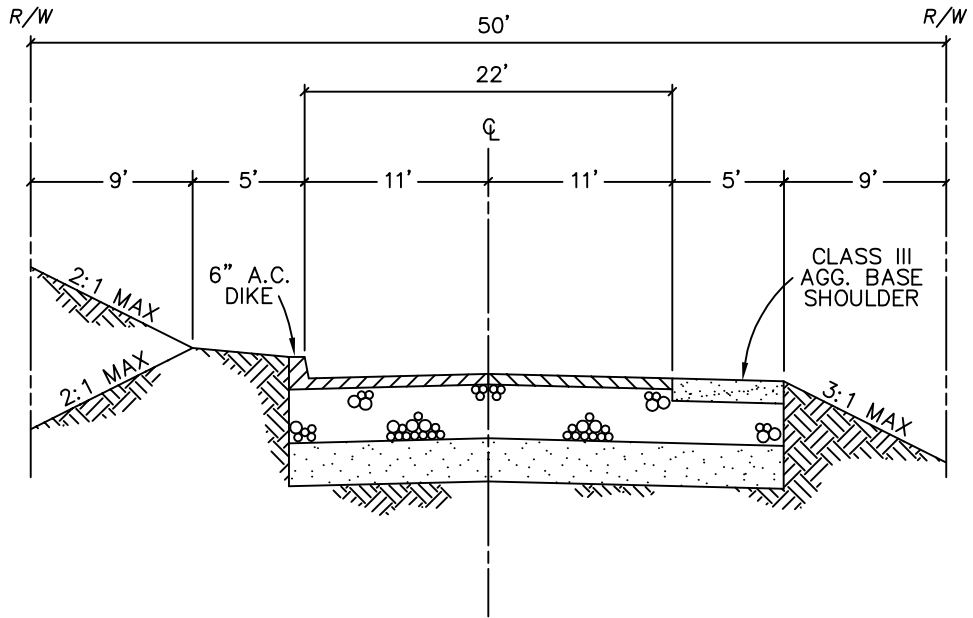

RURAL LOCAL STREET

TRAFFIC INDEX: 6.0
 DESIGN SPEED: 25 MPH

DRAWN BY: KGE	CITY OF PASO ROBLES ENGINEERING DIVISION	DRAWING NO.
DESIGNED BY: JF		A-6
DATE: 08/13	RURAL LOCAL STREET	
FILE NAME: PR-A-6.DWG		

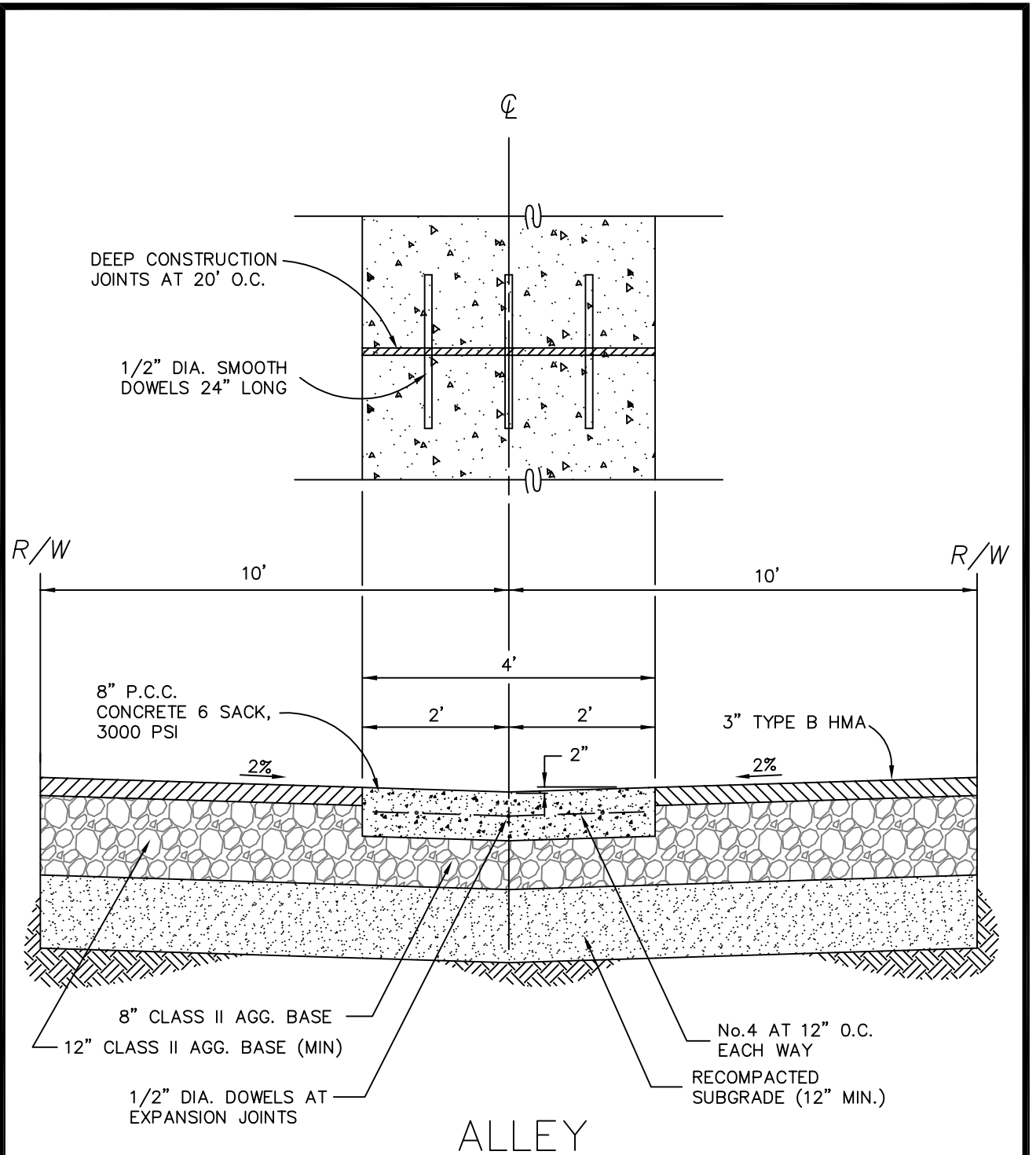

DRAWN BY:
 KGE
 DESIGNED BY:
 JF
 DATE:
 08/13
 FILE NAME:
 PR-A-7.DWG

CITY OF PASO ROBLES
 ENGINEERING DIVISION
 ALLEY

DRAWING NO.
 A-7

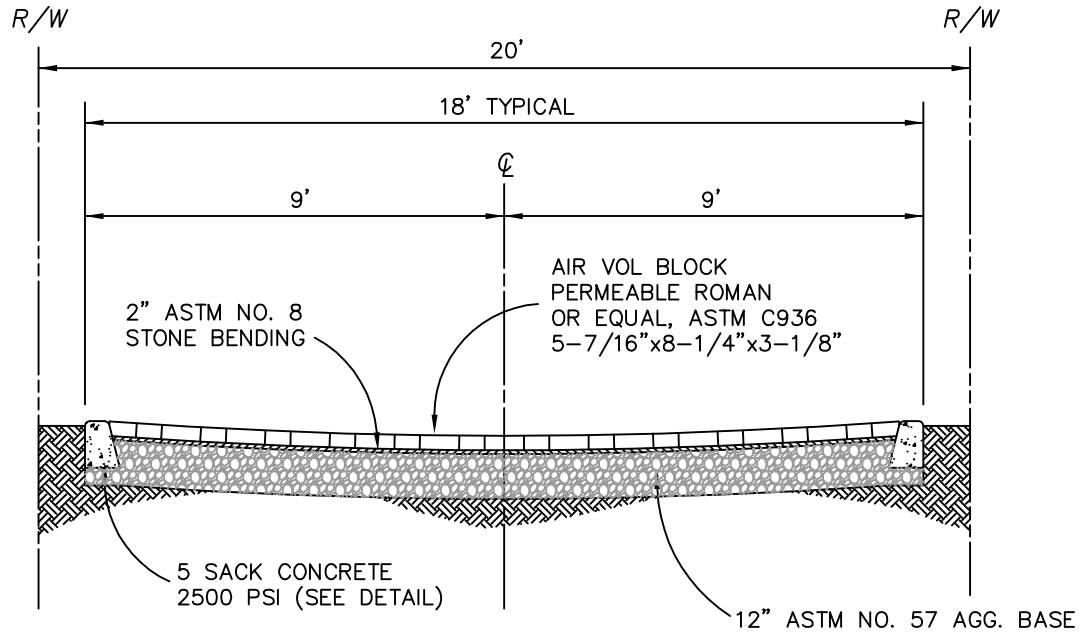

ALLEY

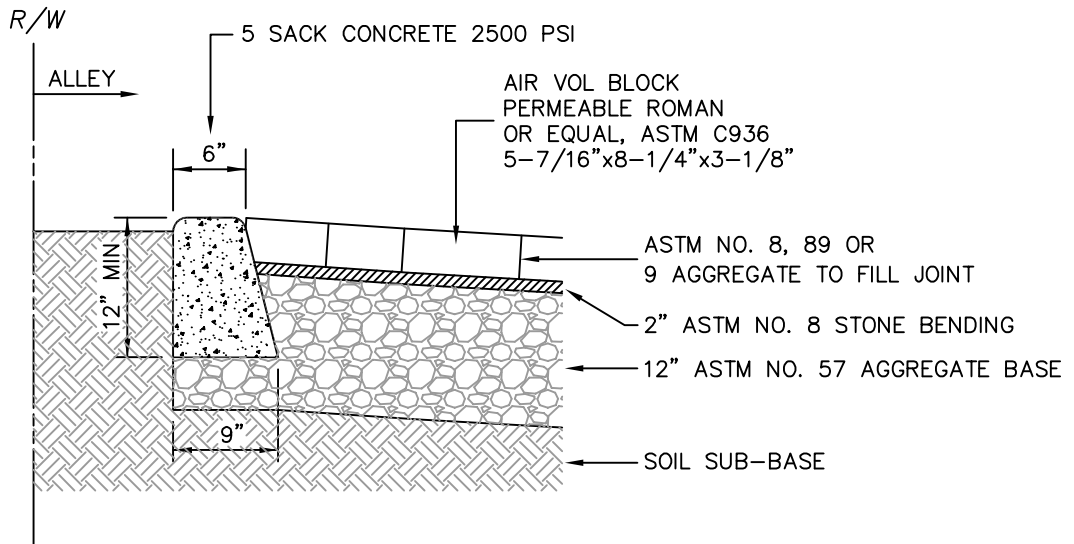

DETAIL

PAVER BLOCK ALLEY

DRAWN BY: KGE	CITY OF PASO ROBLES ENGINEERING DIVISION	DRAWING NO.
DESIGNED BY: JF		
DATE: 02/13	PAVER BLOCK ALLEY	A-8
FILE NAME: PR-A-8.DWG		