

ORDINANCE NO. 608 N.S.
 AN ORDINANCE OF THE CITY OF EL PASO DE ROBLES
 AMENDING THE ZONING MAP ESTABLISHED BY REFERENCE IN
 SECTION 21.12.020 OF THE ZONING REGULATIONS
 (REZONE 89012/CALMONT ASSOCIATES)

WHEREAS, the applicant, Calmont Associates, has requested that the zoning of an approximate 60 acre parcel located north of Sherwood Road, at its intersection with Commerce Way (commonly known as Quail Run Mobile Home Park), be rezoned from R-1,PD to R-4, PD, and

WHEREAS, at its meeting of August 14, 1990, the Planning Commission took the following actions regarding this ordinance:

- a. Considered the facts and analysis, as presented in the staff report prepared for this project;
- b. Conducted a public hearing to obtain public testimony on the proposed ordinance;
- c. Recommended that the City Council adopt the ordinance amending the zoning map as established by the Municipal Code, and

WHEREAS, at its meetings of September 4, 1990 and November 6, 1990, the City Council took the following actions regarding this ordinance:

- a. Considered the facts and analysis, as presented in the staff report prepared for this project;
- b. Considered the recommendation of the Planning Commission regarding this rezone;
- c. Conducted a public hearing to obtain public testimony on the proposed ordinance;
- d. Based on the information contained in the initial studies prepared for this rezone, found that there was no significant effect on the environment and adopted a Negative Declaration in accordance with the California Environmental Quality Act,

NOW, THEREFORE, BE IT ORDAINED by the City Council of the City of El Paso de Robles, California, that Rezone 89012 shall be subject to the following:

SECTION 1: The Zoning Map of the City of El Paso de Robles, dated July 1, 1977, shall be changed as follows:

Section 21.12.020, MAP ALTERATIONS, shall be changed by providing that the existing R-1,PD zoning designation shall be changed to R-4,PD for the property listed below, as described on the 1989 Assessor's Rolls for the County of San Luis Obispo and as shown on Exhibit A (attached):

<u>Assessor's Parcel Number</u>	<u>To Be Zoned</u>
09--571-13	R-4,PD

PASSED AND ADOPTED THIS 4th day of December 1990, by the following roll call vote:

AYES: Reneau, Martin, Picanco and Iversen

NOES: None

ABSENT: Russell



MAYOR CHRISTIAN E. IVERSEN

ATTEST:

JERRY BANKSTON, CITY CLERK

ABJ649

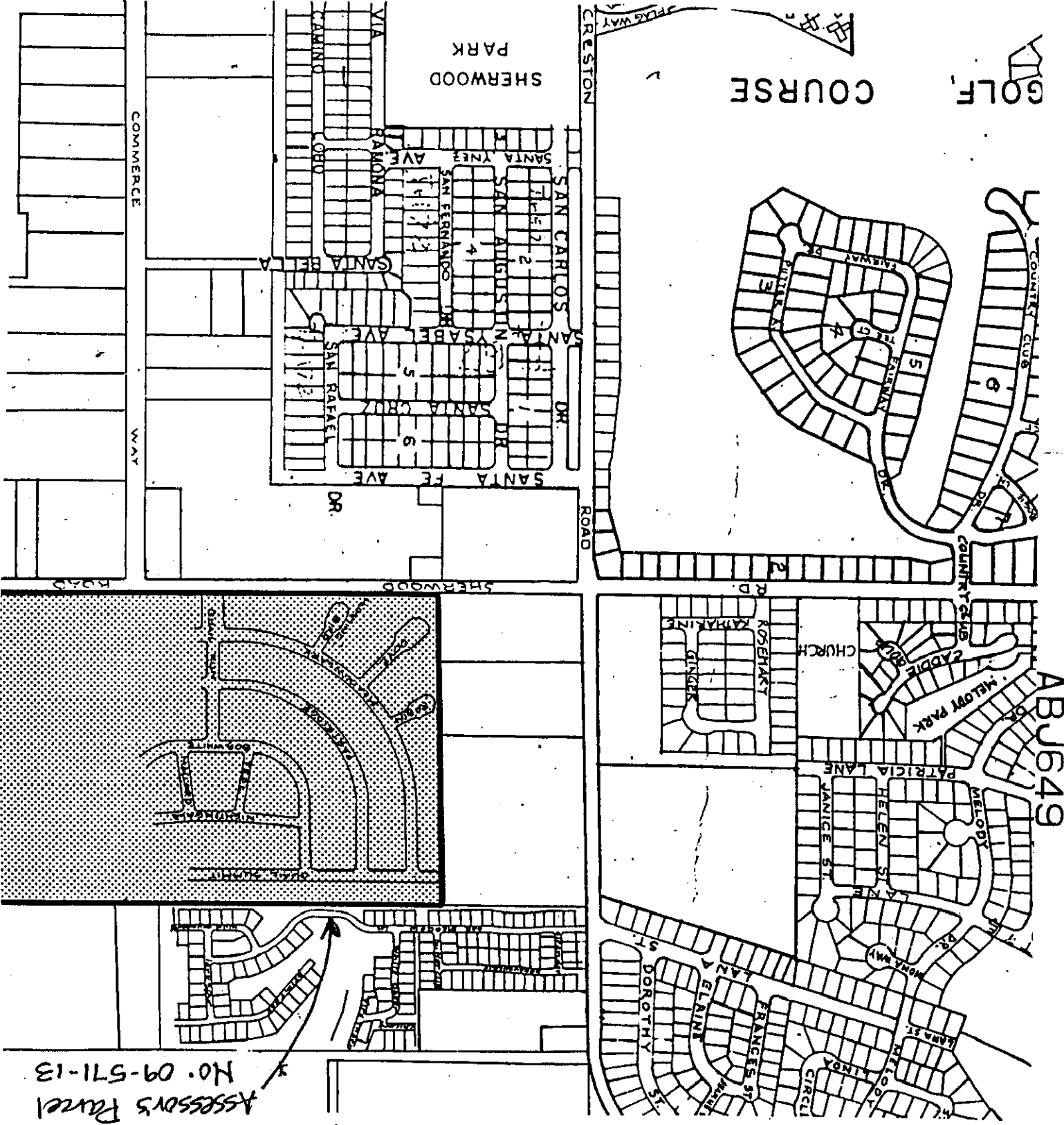
Assessor's Parcel No. 09-571-13



Reszone from R-1, PD to R-4, PD

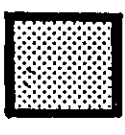

EXHIBIT "A"

REZONE 89012

